

PHASE 1 SITE STATISTICS

SITE AREA	6.08ha (15.04ac)
SINGLE DETACHED	44
TOWNHOME UNITS	64
TOTAL UNITS	108
SALEABLE FRONTAGE	921.5m
R.O.W. CENTRELINE LENGTH	923.0m
RATIO	0.99

PHASE 2 SITE STATISTICS

SITE AREA	7.12ha (17.58ac)
SINGLE DETACHED (10m)	72
TOWNHOME (6m)	112
TOTAL	184
SALEABLE FRONTAGE	1,458.5m
R.O.W. CENTRELINE LENGTH	921.0m
RATIO	1.58
6m WIDE TRAIL LENGTH	776m

PHASE 3 SITE STATISTICS

SITE AREA***	9.09ha (22.46ac)
SINGLE DETACHED (10m)	91
TOWNHOME (6m)	65
SUBTOTAL	156
NON-PROFIT APARTMENT	60
TOTAL	216
SALEABLE FRONTAGE	1,270.9m
R.O.W. CENTRELINE LENGTH	987.8m
RATIO	1.29
6m WIDE TRAIL LENGTH	475m
NON-PROFIT APARTMENT*	0.55ha (1.35ac)

*NOTE: NON-PROFIT APARTMENT FRONTAGE NOT INCLUDED IN SALEABLE FRONTAGE CALCULATIONS.

***NOTE: AREA INCLUDES LIGHT INDUSTRIAL AREA AND THE AREA OF BLOCK 4 FROM THE PHASE 1 DRAFT PLAN TO BE TRANSFERRED TO PHASE 3.

SELF STORAGE STATISTICS (PHASE 3)

AREA LIGHT INDUSTRIAL	1.69ha (4.17ac)
SELF-STORAGE** SITE UNITS	
1.5m x 3.1m (5' x 10')	66
3.1m x 3.1m (10' x 10')	29
3.1m x 4.6m (10' x 15')	48
3.1m x 6.1m (10' x 20')	96
TOTAL	239

**NOTE: "SELF-STORAGE" IS NOT CURRENTLY DEFINED AS A USE IN THE CITY OF THOROLD OFFICIAL PLAN OR ZONING BY-LAW. PLANNING APPROVAL PROCESS WILL BE REQUIRED TO ALLOW THIS USE.

SITE SUMMARY

AREA	
PHASE 1	6.08ha (15.04ac)
PHASE 2	7.12ha (17.58ac)
PHASE 3	7.32ha (18.1ac)
LIGHT INDUSTRIAL	1.69ha (4.17ac)
TOTAL AREA	22.21ha (54.89ac)
RESIDENTIAL UNIT COUNT	
SINGLE DETACHED	207
TOWNHOME	241
SUBTOTAL	448
NON-PROFIT APARTMENT	60
TOTAL	508
SALEABLE FRONTAGE	3,650.9m
R.O.W. CENTRELINE LENGTH	2,831.8m
RATIO	1.29
6m WIDE TRAIL LENGTH	1,251m

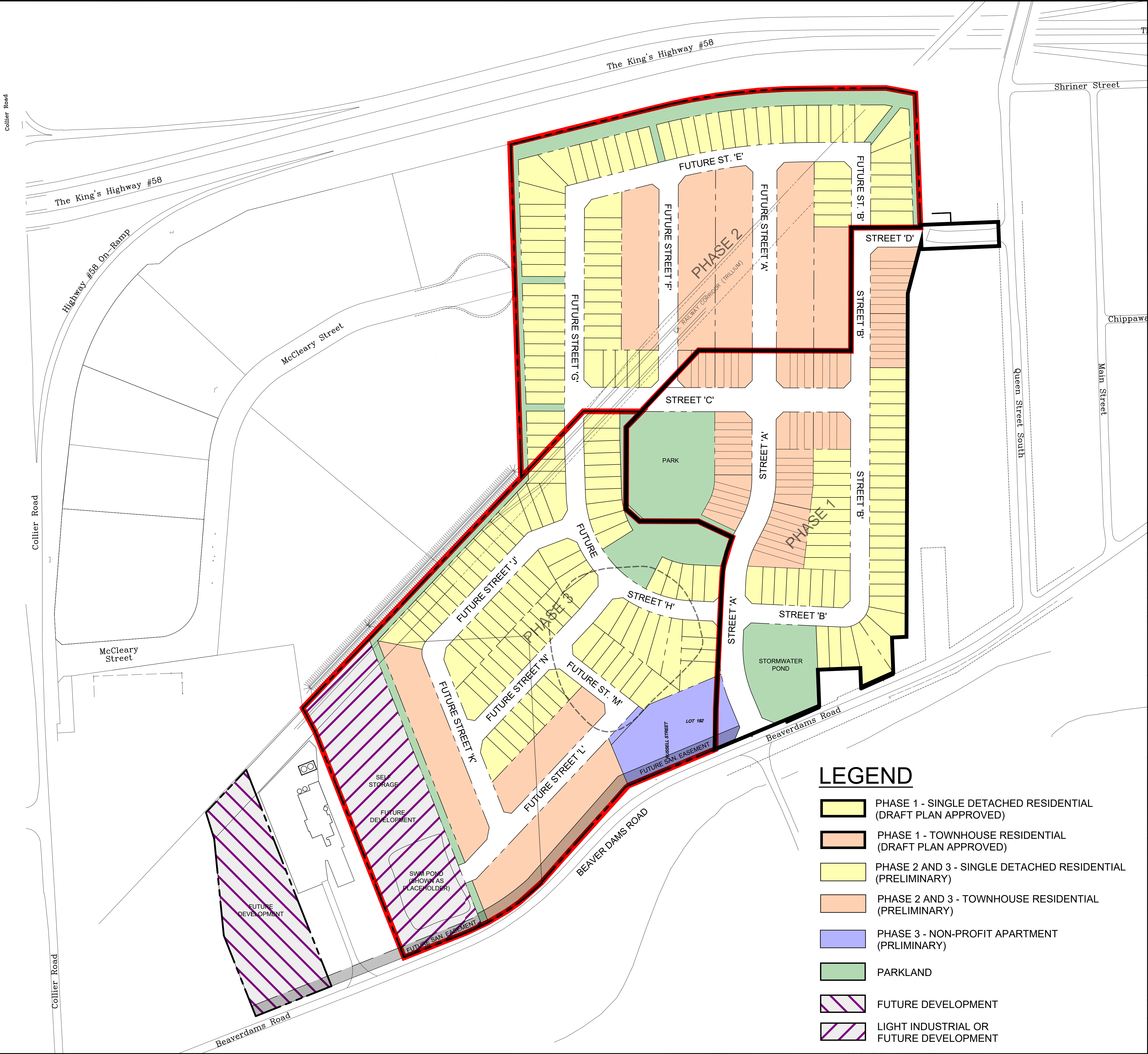

LEGEND

- PHASE 1 - SINGLE DETACHED RESIDENTIAL (DRAFT PLAN APPROVED)
- PHASE 1 - TOWNHOUSE RESIDENTIAL (DRAFT PLAN APPROVED)
- PHASE 2 AND 3 - SINGLE DETACHED RESIDENTIAL (PRELIMINARY)
- PHASE 2 AND 3 - TOWNHOUSE RESIDENTIAL (PRELIMINARY)
- PHASE 3 - NON-PROFIT APARTMENT (PRLIMINARY)
- PARKLAND
- FUTURE DEVELOPMENT
- LIGHT INDUSTRIAL OR FUTURE DEVELOPMENT

LEGAL DESCRIPTION

LEGEND

REVISIONS

E	INFORMATION	21-MAR-2016	JW
D	INFORMATION	20-MAR-2016	JW
C	INFORMATION	16-MAR-2016	JW
B	INFORMATION	25-NOV-2016	JW
A	REVIEW	27-OCT-2016	JW
REV.	DESCRIPTION	DATE	INIT.

DISCLAIMER
THIS DRAWING IS THE INTELLECTUAL PROPERTY OF T. JOHNS CONSULTING GROUP LTD. AND IS PROTECTED UNDER COPYRIGHT.
ANY DISCREPANCIES SHALL BE REPORTED TO T. JOHNS CONSULTING GROUP LTD. PRIOR TO THE START OF CONSTRUCTION.
THIS DRAWING IS NOT TO BE USED FOR CONSTRUCTION UNLESS OTHERWISE INDICATED.

T. JOHNS CONSULTING GROUP
URBAN PLANNING | DESIGN | PROJECT MANAGEMENT
310 LIMERIDGE ROAD WEST
HAMILTON ONTARIO, L9C 2V2
P 905-574-1993
F 905-527-9559

PROJECT TITLE

ARTISAN RIDGE

THOROLD, ONTARIO

DRAWING TITLE

DEVELOPMENT CONCEPT PLAN

DRAWN BY	DESIGNED BY
JW	JW/JP
PRINT DATE	PROJECT NUMBER
21-Apr-2017	0101
REVISION	DRAWING NUMBER
E	
SCALE	
1:1500	

DCP1-1